

# Ampco Centrifugal Pumps

DATA SHEET

MODEL ZCM/ZCHM 4x3

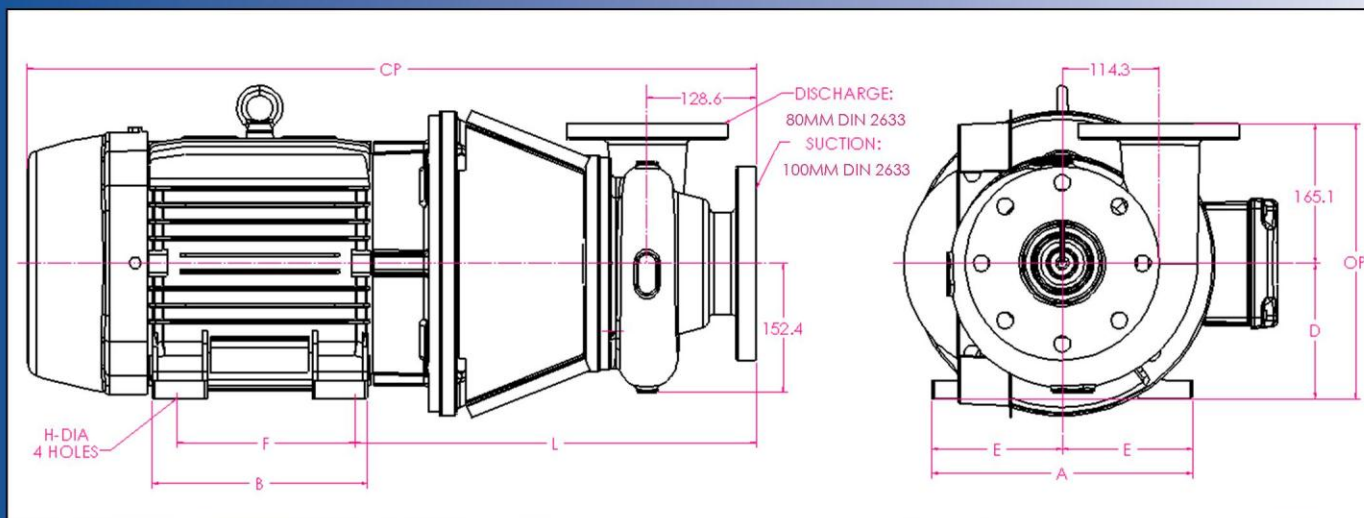
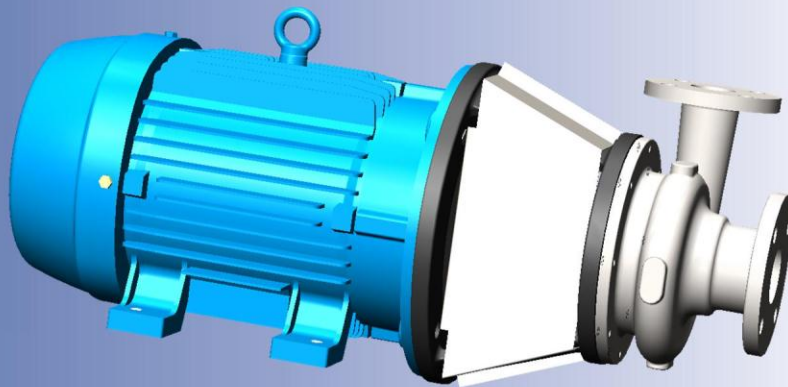

| IEC MOTOR |                                | DIMENSIONS IN MM (For Reference Only) |         |       |       |       |      |       |       |       | APPROX. WEIGHT (KG) |
|-----------|--------------------------------|---------------------------------------|---------|-------|-------|-------|------|-------|-------|-------|---------------------|
| FRAME     | KW/RPM                         | A (max)                               | B (max) | D     | E     | F     | H    | L     | CP    | OP    |                     |
| 80        | 0.75/1450; 0.75/2900; 1.1/2900 | 155.1                                 | 124.0   | 80.0  | 65.6  | 100.0 | 10.0 | 328.6 | 513.1 | 245.1 | 54                  |
| 90S       | 1.1/1450; 1.5/2900             | 169.4                                 | 144.9   | 90.0  | 70.0  | 100.0 | 10.0 | 331.6 | 555.1 | 255.1 | 59                  |
| 90L       | 1.5/1450; 2.2/2900             | 169.4                                 | 144.9   | 90.0  | 70.0  | 125.0 | 10.0 | 331.6 | 555.1 | 255.1 | 63                  |
| 100L      | 2.2/1450; 3/2900               | 196.0                                 | 170.0   | 100.0 | 80.0  | 140.0 | 12.0 | 353.0 | 606.0 | 265.1 | 73                  |
| 112M      | 4/1450; 4/2900                 | 220.0                                 | 177.0   | 112.0 | 95.0  | 140.0 | 12.0 | 360.0 | 624.0 | 277.1 | 85                  |
| 132S      | 5.5/1450; 5.5/2900; 7.5/2900   | 248.0                                 | 187.0   | 132.0 | 108.0 | 140.0 | 12.0 | 419.2 | 700.8 | 297.1 | 122                 |
| 132M      | 7.5/1450                       | 248.0                                 | 187.0   | 132.0 | 108.0 | 178.0 | 12.0 | 419.2 | 700.8 | 297.1 | 122                 |
| 160M      | 11/1450; 11/2900; 15/2900      | 308.0                                 | 254.0   | 160.0 | 127.0 | 210.0 | 14.5 | 481.1 | 861.1 | 325.1 | 176                 |
| 160L      | 15/1450; 18.5/2900             | 308.0                                 | 254.0   | 160.0 | 127.0 | 254.0 | 14.5 | 481.1 | 861.1 | 325.1 | 198                 |
| 180M      | 18.5/1450; 22/2900             | 350.0                                 | 294.0   | 180.0 | 139.5 | 241.0 | 14.5 | 494.2 | 926.8 | 345.1 | 233                 |
| 180L      | 22/1450                        | 350.0                                 | 294.0   | 180.0 | 139.5 | 279.0 | 14.5 | 494.2 | 926.8 | 345.1 | 251                 |

## MATERIAL SPECIFICATIONS

| PART NAME                | NICKEL ALUMINUM BRONZE | STAINLESS STEEL |
|--------------------------|------------------------|-----------------|
| Casing, Cover & Impeller | AMPCO® 483             | 316 Stainless   |
| Wear Ring                | AMPCO® 18              | 316 Stainless   |
| Motor Shaft              | Steel                  | Steel           |
| Shaft Sleeve             | AMPCO® 18              | 316 Stainless   |
| Adapter                  | Cast Iron              | Cast Iron       |

\* Also available in Duplex 2205

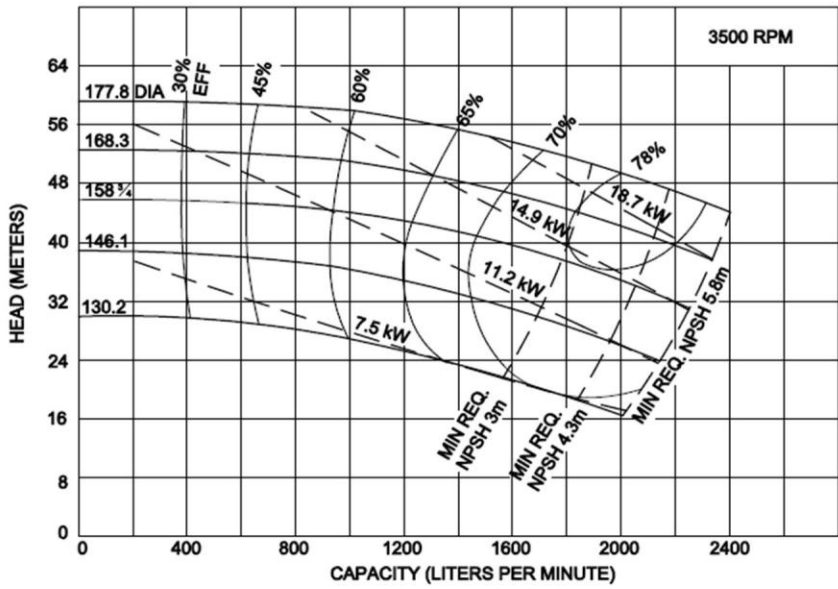

# Ampco Centrifugal Pumps

## MODEL ZCM/ZCHM 4x3

Curves show approximate characteristics  
Based on clear 20° water.  
Rated point is guaranteed.

Heavy-duty Z Series pumps have maximum wall thickness and Din PN10 flanged connections.

Seal options include Type 21, Type 1 and Type 9 with choice of sealing materials.

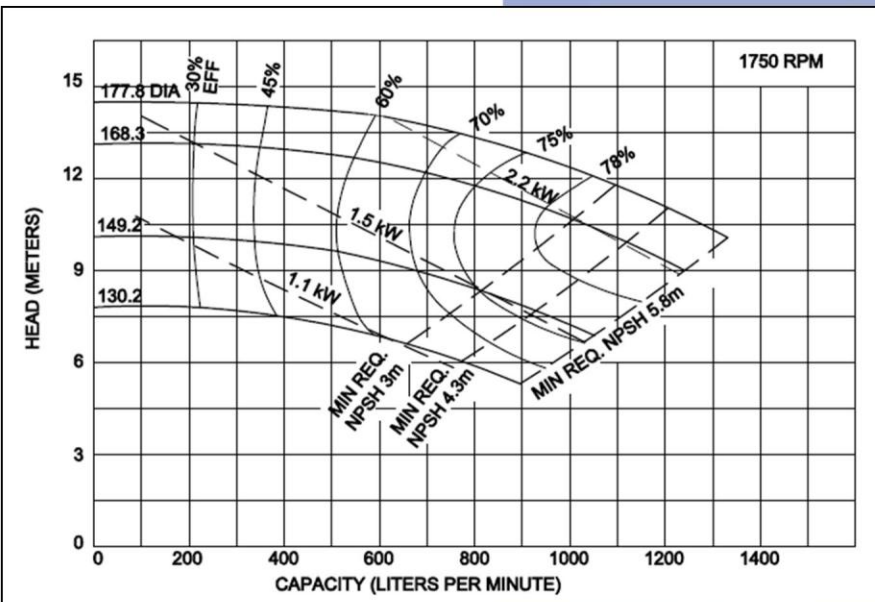
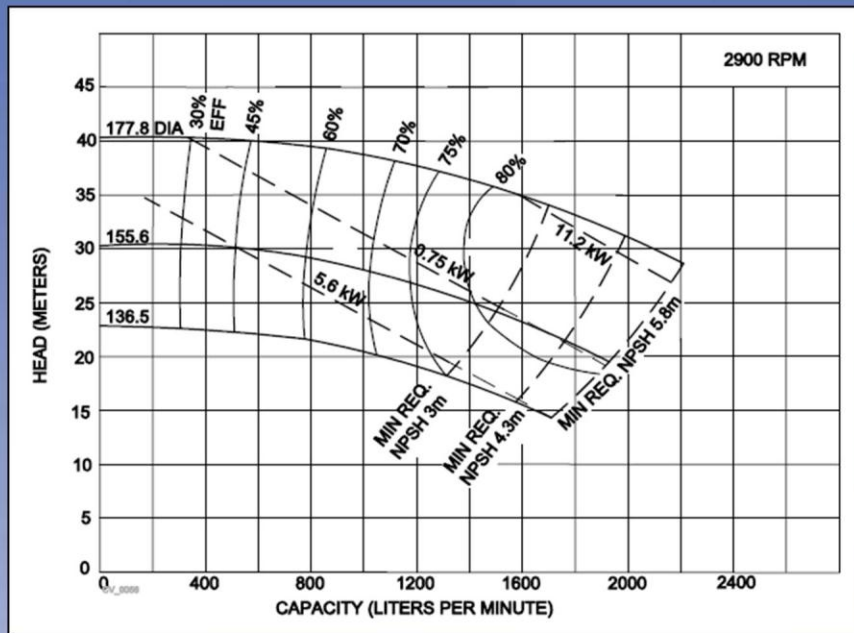

## Ampco Pumps Company

2045 West Mill Road  
Glendale, WI 53209  
Phone: (414) 643-1852  
Fax: (414) 643-4452

