

Ampco Centrifugal Pumps

DATA SHEET

MODEL MC3/MCH3 4X2¹/₂X8¹/₂

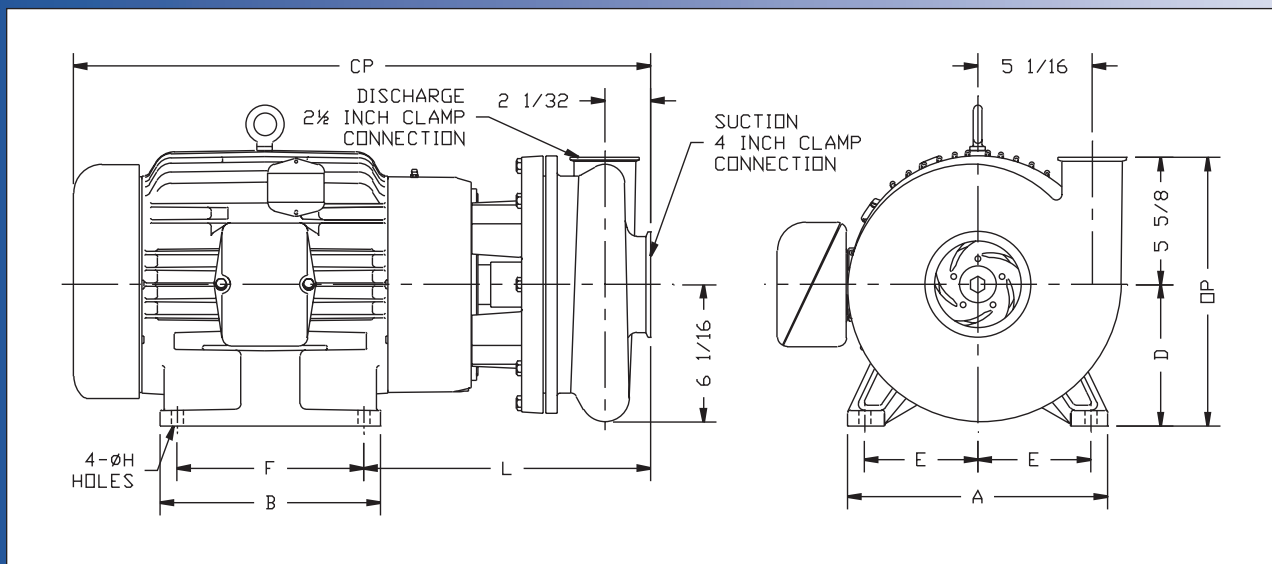
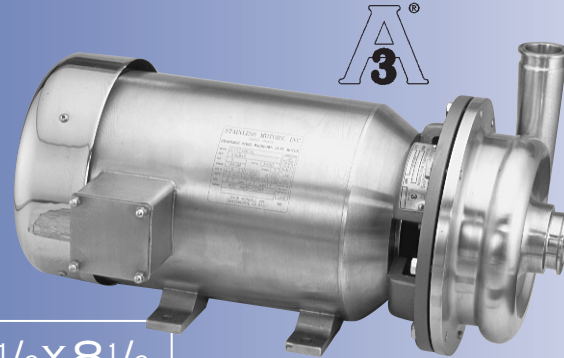

TEFC MOTOR			DIMENSIONS IN INCHES (For Reference Only)									APPROX.
HP	RPM	FRAME	A (max)	B (max)	D	E	F	H	L	CP	OP	
1-1/2	1750	145JM	6-1/2	6	3-1/2	2-3/4	5	11/32	9-1/2	17-7/8	9-1/8	113
2	1750	145JM	6-1/2	6	3-1/2	2-3/4	5	11/32	9-1/2	17-7/8	9-1/8	119
3	1750	182JM	8-5/8	6-1/2	4-1/2	3-3/4	4-1/2	13/32	10-1/8	19-1/4	10-1/8	131
5	1750	184JM	8-5/8	6-1/2	4-1/2	3-3/4	5-1/2	13/32	10-1/8	20-3/4	10-1/8	155
7-1/2	1750	213JM	9-1/2	8	5-1/4	4-1/4	5-1/2	13/32	11-1/8	22-1/8	10-7/8	203
10	1750	215JM	9-1/2	8	5-1/4	4-1/4	7	13/32	11-1/8	23-3/8	10-7/8	207
15	1750	254JM	11-1/2	9-3/4	6-1/4	5	8-1/4	17/32	12-11/16	25-1/2	11-7/8	303
15	3500	254JM	11-1/2	9-3/4	6-1/4	5	8-1/4	17/32	12-11/16	25-1/2	11-7/8	289
20	3500	256JM	11-1/2	11-1/2	6-1/4	5	10	17/32	12-11/16	27-1/4	11-7/8	330
25	3500	284JM	12-3/4	12-3/4	7	5-1/2	9-1/2	17/32	12-11/16	31-1/8	12-5/8	448
30	3500	286JM	12-3/4	12-3/4	7	5-1/2	11	17/32	12-11/16	31-1/8	12-5/8	450
40	3500	324JM	14-1/2	14	8	6-1/4	10-1/2	21/32	13-3/16	33	13-5/8	556
50	3500	326JM	14-1/2	14	8	6-1/4	12	21/32	13-3/16	33	13-5/8	642
60	3500	364Z	16-1/2	14-1/2	9	7	11-1/4	21/32	14-1/16	35	14-5/8	814
75	3500	365Z	16-1/2	14-1/2	9	7	11-1/4	21/32	14-1/16	35	14-5/8	840

PART NAME	STAINLESS STEEL
CASTING, IMPELLER & COVER	316L STAINLESS STEEL
SHAFT SLEEVE & IMPELLER SCREW	316L STAINLESS STEEL
MOTOR SHAFT	STEEL
ADAPTER	CAST IRON

Ampco Centrifugal Pumps

MODEL MC3/MCH3 4X2 1/2 X 8 1/2

Curves show approximate characteristics based on clear 68° water. Rated point is guaranteed.

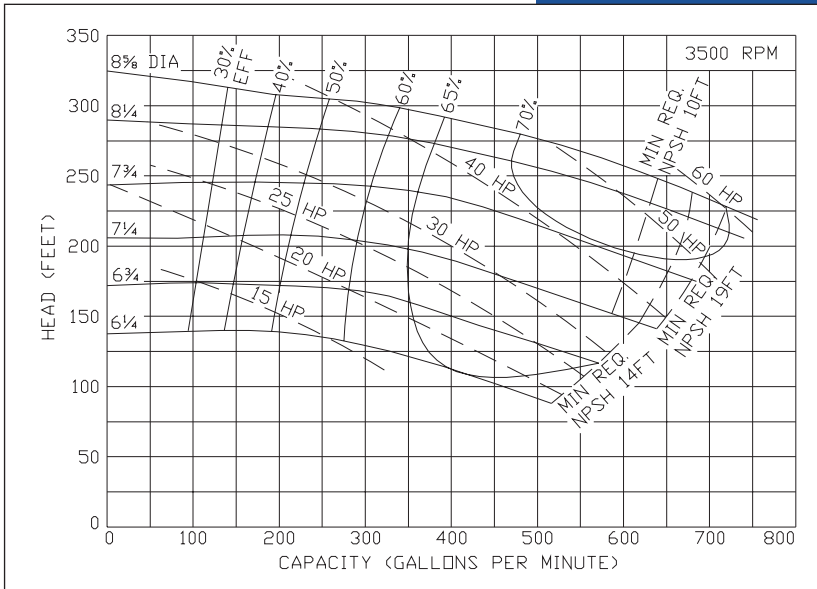

MC3/MCH3 pumps are in conformance with 3A sanitary standards for centrifugal pumps for milk and milk products, Number 02-09.

Standard M Series pumps have a 32RA (150 grit) finish, on all product contact surfaces.

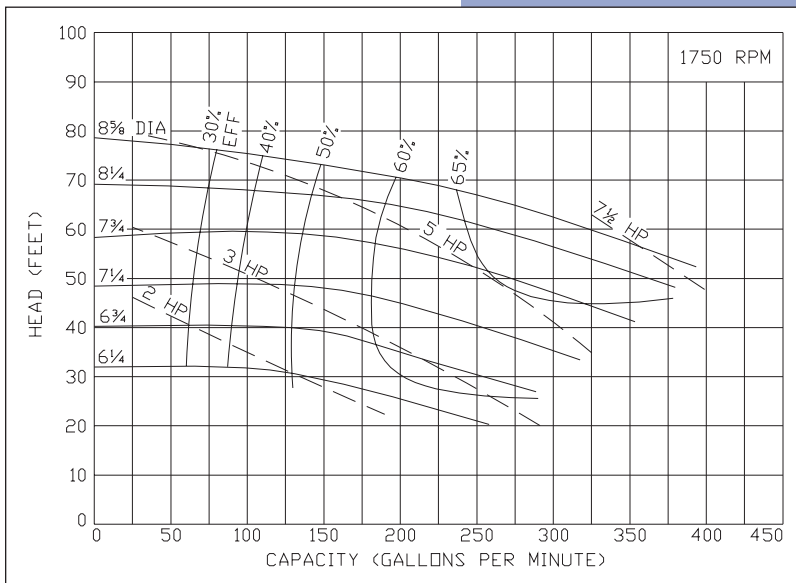
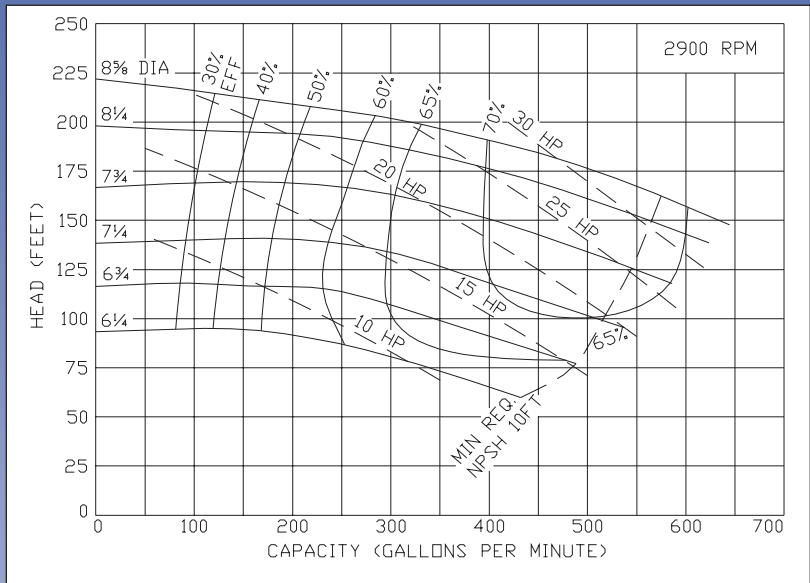

Ampco Pumps Company

4424 West Mitchell Street
Milwaukee, Wisconsin 53214
PHONE (414) 643-1852
FAX (414) 643-4452