

**EC/ECH PUMPS w/ PACKING**  
**ZC/ZCH PUMPS**

1<sup>1</sup>/<sub>2</sub>x1<sup>1</sup>/<sub>4</sub>, 2x1<sup>1</sup>/<sub>2</sub>, 2<sup>1</sup>/<sub>2</sub>x2, 3x2<sup>1</sup>/<sub>2</sub>, 4x3

**AMPCO PUMPS COMPANY**  
**PARTS BREAKDOWN**

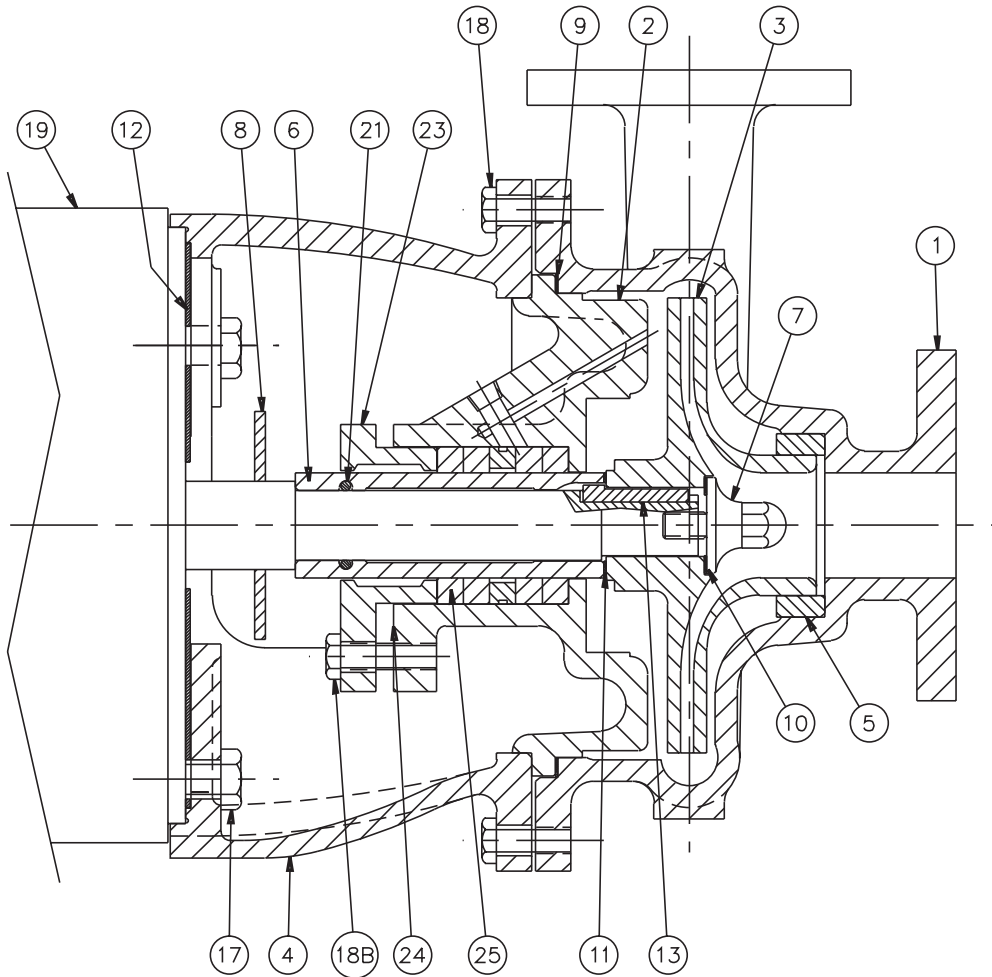

DETAIL NO.	REQ. NO.	PART NAME
25	1	PACKING RINGS
24	1	GLAND GASKET
23	1	GLAND
22 <sup>1,2</sup>	1	WEAR RING (COVER)
21	1	O-RING (SHAFT/SLEEVE)
20 <sup>1</sup>	2	PIPE PLUG (OPTIONAL)
19	1	MOTOR
18B	2	CAP SCREW (COVER/GLAND)
18	8	CAP SCREW (CASING/ADAPTER)
17	4	CAP SCREW (MOTOR/ADAPTER)
16 <sup>1</sup>	2	DRIVE SCREW
15 <sup>1</sup>	1	NAME PLATE
13	1	IMPELLER KEY
12	1	SPLASH PLATE
11	1	GASKET or O-RING (SLEEVE/IMPELLER)
10	1	GASKET or O-RING (IMPELLER SCREW)
9	1	GASKET (CASING/COVER)
8	1	SLINGER
7	1	IMPELLER SCREW
6	1	SHAFT SLEEVE
5	1	WEAR RING (SUCTION)
4	1	ADAPTER
3	1	IMPELLER
2	1	COVER
1	1	CASING

<sup>1</sup>NOT SHOWN

<sup>2</sup>ONLY ON 4x3

NOTE: Please be sure to always include pump type, size, and serial number with any reference to above numbers and names.