

Ampco Pumps Company

New ZP3 Pump

Ampco's new ZP3 pump is now available in all sizes up to the 220 model. This unique design offers multiple advantages over the competition including front loading seals and in-line clean-ability with a new rotor case design to ensure maximum efficiency. In addition, the entire gear case assembly, including shafts, is identical to ZP2 style pumps with 100% parts interchangeability. ZP3 pumps are in conformance with 3-A standards and are currently being tested for EHEDG certification.

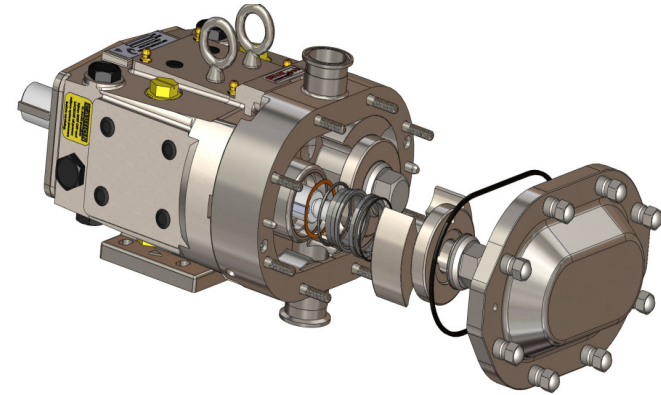

Another exciting feature of the ZP3 design is that we can upgrade your existing ZP2 pumps (and our competitors' similar pumps) with new rotors, new seals and re-machining the existing rotor case. You'll get all the benefits of the ZP3 design for little more than the cost of a standard rebuild. Ask our inside sales department for details next time you send a ZP2 style pump in for reconditioning.

Process Expo 2011

Ampco will be exhibiting at Process Expo 2011 in Chicago from November 1st-4th. Please stop in at booth #3614 to see the new ZP3 pump and the rest of our sanitary product line, including ZL lobe style pumps, LC/LF centrifugal pumps, LH high pressure pumps and AC/AC+ centrifugal pumps.

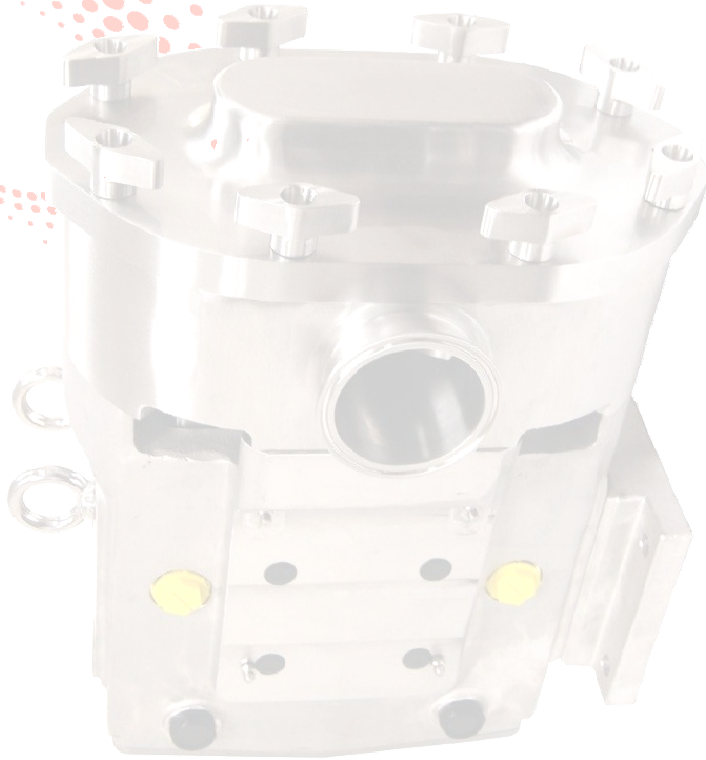

Ampco Pumps Company

2045 West Mill Road

Glendale, Wisconsin 53209

Ph: 414.643.1852

Fx: 414.643.4452

www.ampcopumps.com

Email: ampcocs@ampcopumps.com

Ampco Exhibits at IDA World Congress

In September, we exhibited our duplex 2205 and nickel aluminum bronze centrifugal pumps at the International Desalination Association World Congress in Perth, Australia. After attending the 2009 conference in Dubai, UAE we felt this would be a good opportunity to expand our reputation in the seawater reverse osmosis community. Manufacturers from all over the world were represented in Perth. The show was fascinating. Australia is great, but as they say "it's a bloody long way to go."

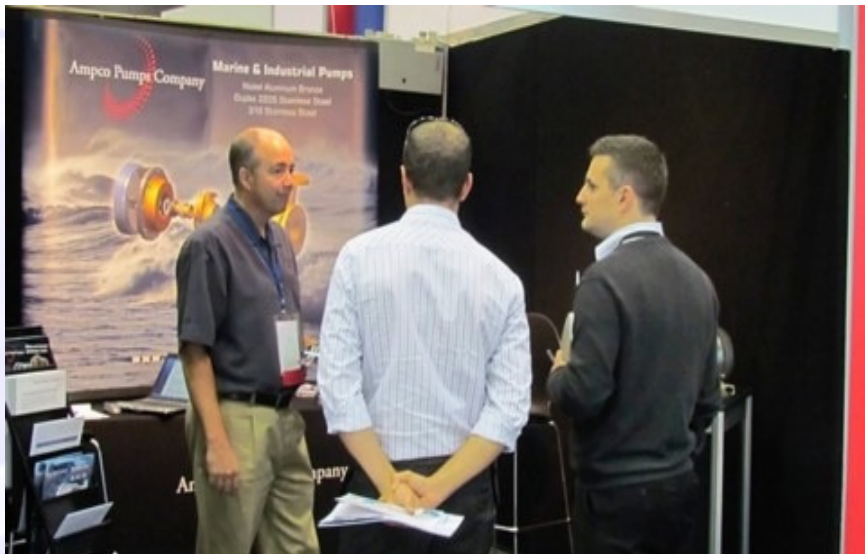

Technical Training

We are offering another training course this October 18th & 19th. The 1-1/2 day session will focus on sanitary products and include a full day classroom session followed by a half day of hands-on training in the shop. The session will be taught by Steve Schuetz, Eastern Region Sales Manager and Layne Meyers, PD Product Manager. Participants are responsible for all travel arrangements and Ampco will provide food and lodging. If you have an interest in attending this session, please contact your regional sales manager or the Milwaukee office 414-643-1852 x114

Dan Heronema
dheronema@ampcopumps.com

(480) 699-0259 (West Region)

Larry King
lking@ampcopumps.com

(608) 695-1948 (Central Region)

Steve Schuetz
sschuetz@ampcopumps.com

(608) 234-2933 (NE Region)

Stefan Andresen
Stefan.andresen@ampcopumps.de

49 151 149 04309 (International)

Brian Dimico
bdimico@ampcopumps.com

(800) 862-5611 (International Marine Product Mgr)

JP Phillips
jphillips@ampcopumps.com

(561) 573-2364 (SE Region)

Sr. Project Engineer/Tech. Sales: Peter Kolev Ext. #120
pkolev@ampcopumps.com

Project Engineer/Tech. Sales: Joel Wilde Ext. #116
jwilde@ampcopumps.com

Inside/Technical Sales: Michelle Balota Ext. #121
mbalota@ampcopumps.com

Order Status & Parts Orders: Megan Bethke Ext. #130
mbethke@ampcopumps.com

Inside Sales: Angie Holmes Ext. #135
aholmes@ampcopumps.com

Administrative Assistant: Elizabeth Abadia Ext. #114
eabadia@ampcopumps.com

Accounts Receivables: Amy Arquette Ext. #119
aarquette@ampcopumps.com

****Win a Starbucks Gift Card****

What is the model name of Ampco's new PD pump and name three benefits and/or upgrades that make this pump so desirable to end users?

Please fax your response to 414-643-4452 no later than October 15th .

Good Luck!